

## Engineering Log - Hand Auger

Hand Auger No. **GIHA01**

Sheet 1 of 1  
Project No: **GENZSILV14388AA-GI**

Client: **WAITEMATA DISTRICT HEALTH BOARD**

Date started: 7.8.2009

**Principal:**

Date completed: **7.8.2009**

Project: **DENTAL FACILITY - GLENFIELD INTERMEDIATE**

Logged by: **LS**

Hand Auger Location: ***Refer to site plan***

Checked by: **LS**

drilling information		material substance												
stratigraphy	water	notes samples, tests, etc	RL	depth metres	graphic log	classification symbol	material Soil type; colour, structure. Grading; bedding; plasticity, sensitivity. Secondary and minor components, additional information.	moisture condition	consistency/ density index	vane shear (remoulded) (kPa)	structure and additional observations			
Fill			50.5	0.5		ML	TOPSOIL	H						
Residual Waitemata Group			50.0	1.0		ML	Slightly clayey SILT; light brown/light grey streaked orange, medium plasticity with minor rootlets and minor gravels, angular	M						
Residual Waitemata Group			49.5	1.5		ML	Clayey SILT; light brown streaked orange, medium plasticity							
Residual Waitemata Group			49.0	2.0		ML	Fine sandy slightly clayey SILT; light brown/light grey streaked orange, low plasticity							
Residual Waitemata Group			48.5	2.5		SC	Clayey SAND; light grey streaked orange, medium plasticity, fine grained							
Residual Waitemata Group			48.0	3.0		CL	Sandy CLAY; light grey streaked orange/dark orange, low plasticity							
Residual Waitemata Group			47.5	3.5		CL	Slightly fine sandy silty CLAY; light grey streaked orange and pink, medium plasticity							
Residual Waitemata Group			47.0	4.0		ML	Slightly fine sandy clayey SILT; light grey/light brown streaked orange and pink, medium plasticity							
Borehole G1H401 terminated at 3.2 metres.														

classification symbols and soil description based on Field Description of Soil and Rock, New Zealand Geotechnical Society Inc 2005

vane shear (kPa)

● remoulded

X peak

>>X peak greater than 200kPa

UTP unable to penetrate

water

10/1/88 water level on date shown

— water inflow

— water outflow

moisture

D dry

M moist

W wet

S saturated

consistency/ density index

VS very soft

S soft

F firm

St stiff

VSt very stiff

H hard

VL very loose

L loose

MD medium dense

O dense

VD very dense

FOR INFORMATION ONLY - ~~COPY RIGHT~~

COPY FROM  
FOR INFORMATION  
ONLY



Lot 15  
DP 49471

Lot 14  
DP 49471

Lot 13  
DP 49471

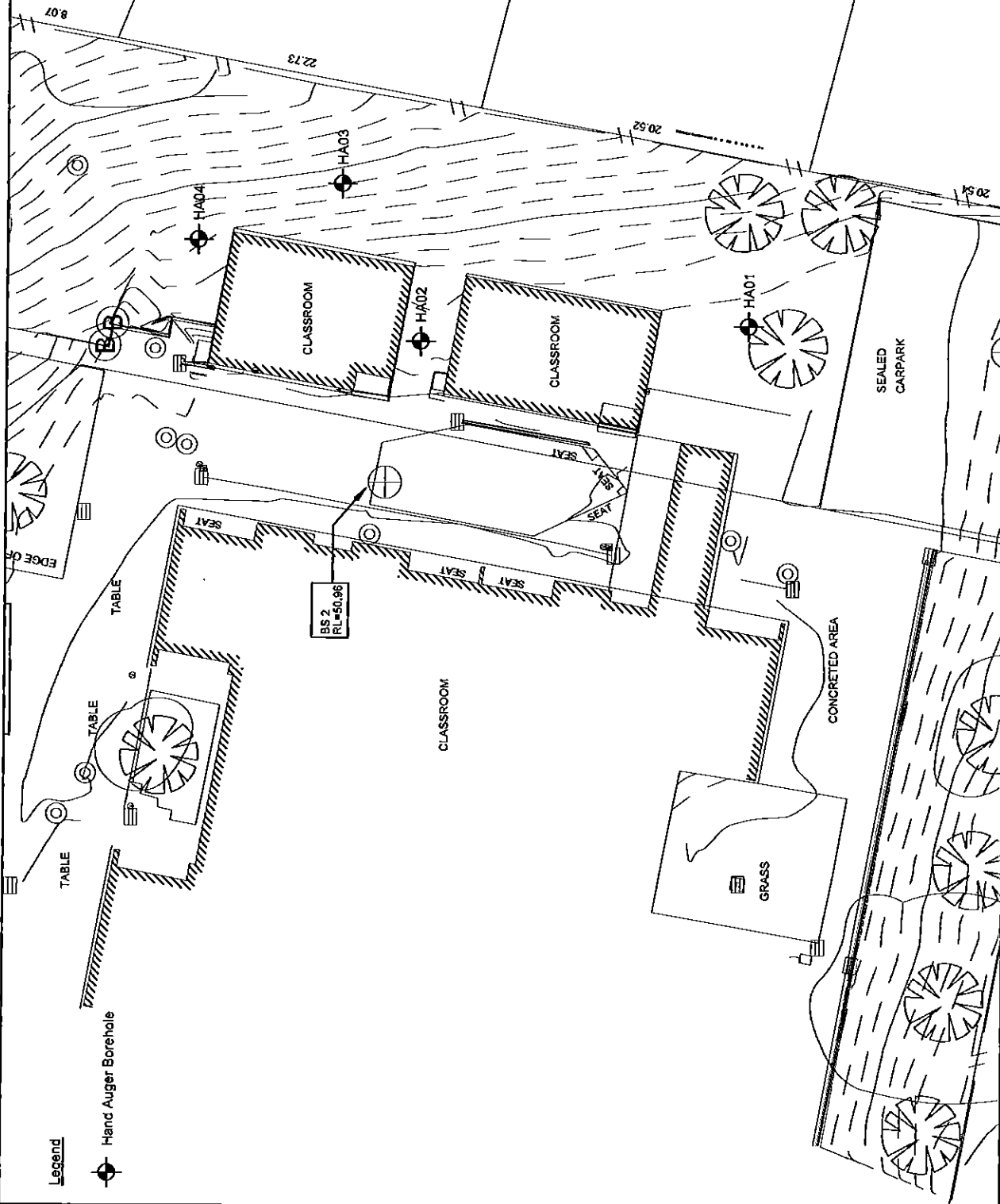

Legend

Hand Auger Borehole

**coffey**  
geotechnics  
SPECIALISTS MANAGING  
THE EARTH

client: WAITEMATA DISTRICT HEALTH BOARD

project: DENTAL FACILITY ROLLOUT - GLENFIELD  
INTERMEDIATE

title: SITE PLAN

project no: GENZSILV14388AA-GI figure no: 01

drawn	PD
approved	LS
date	11/08/09
scale	1:250
original	A3
size	

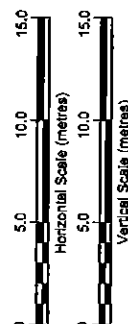

description	drawn	approved	date
revision			